

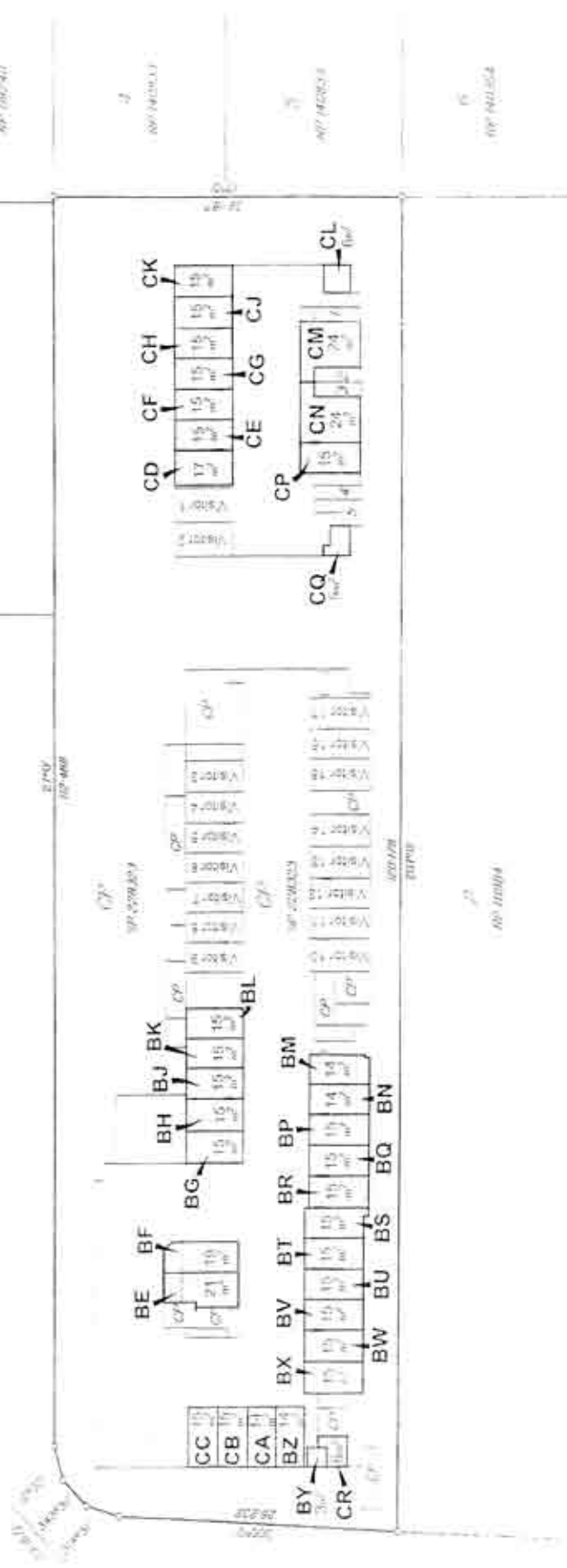

MARADA STREET

STREET

LOGAN ROAD



Level B

These plans are for contract purposes only. They have been produced from Architectural drawings and are subject to final survey. They are not for registration purposes.

| PLAN | OF | EXCLUSIVE | USE |
|---|------------------------|-------------|-------|
| COMMUNITY TITLE SCHEME | | | |
| Site Address 12501-12503 (odd) Road, Upper Mount Gravatt Borough of Brisbane, County of Stanley | ZACHARY DEVELOPMENTS | | |
| CONSULTING SURVEYORS 15-17 Sandstone Drive, Mt Gravatt QLD 4012 | CLIENT | PLAN NUMBER | |
| | 12501-12503 (odd) Road | 60312-EX12 | |
| | DATE OF SP | SCALE | TITLE |
| | 22/05/23 | 1:400 | CONV |